

# BONITRON

521 Fairground Court Nashville, TN

Bonitron.com / 615-244-2825

150 - 800 W

IP 54 Aluminium Resistors

cRUus 600/1000 V

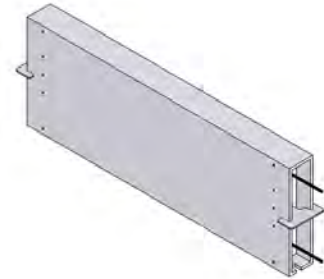
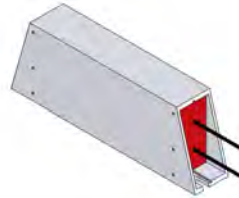

BONITRON							
Part Number	Voltage Rating	Nominal Drive HP	Peak Drive HP	Ohms	Peak Watts	Nominal Cont. Power (W) $T_a \sim 40^\circ\text{C}$	Max Brake Pulse Time
RS CRML001HP-54	230V	1 HP	1.5 HP	125 $\Omega$	1,125 W	150 W	50 Seconds
RS CRML002HP-54	230V	2 HP	3 HP	62.5 $\Omega$	2,250 W	300 W	30 Seconds
RS CRML005HP-54	230V	5 HP	7.5 HP	25 $\Omega$	5,625 W	800 W	15 Seconds
RS CRMH001HP-54	480V	1 HP	1.5 HP	500 $\Omega$	1,125 W	150 W	50 Seconds
RS CRMH002HP-54	480V	2 HP	3 HP	250 $\Omega$	2,250 W	300 W	30 Seconds
RS CRMH005HP-54	480V	5 HP	7.5 HP	100 $\Omega$	5,625 W	800 W	15 Seconds
Resistance Values at 20°C (Ohm)				2.5 - 910 (1HP)	6.2 - 1300 (2HP)	3.9 - 450 (5HP)	
Tolerance of resistance at 20°C				±10%			
Degree of protection (EN 60529) (in the accordingly screwed on state)				IP 54			
Max. permissible operating voltage				UL 600 / 1000 V			
Cooling				natural convection			
Approvals/markings				UL; CSA			
Operation temperature range				-25 ... +40 °C			
Testing voltage				2.7 kV AC 1 s			
Mounting positions							

Subject to technical modifications

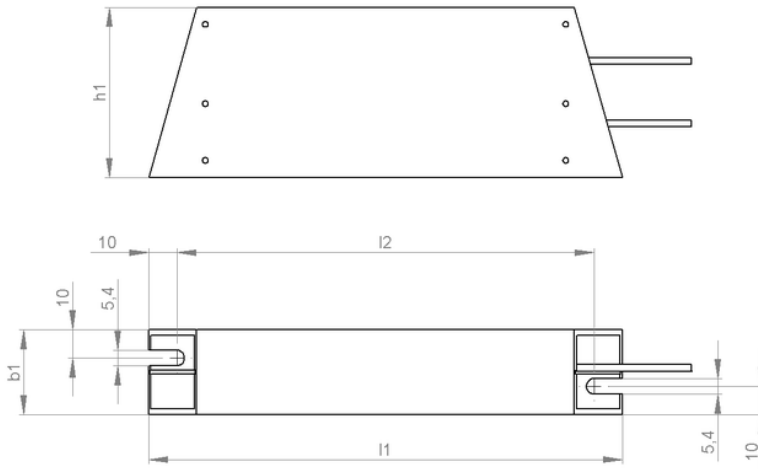

Article-No.		BONITRON		
Type		1 HP(Above)	2 HP(Above)	5 HP(Below)
Length [mm]	l1fl	@!3	@!3	% )
	l#	#()	2()	%%)
	l\$	# "	\$ "	%\$
Width [mm]	b1fl	@!3	@!3	&
	b#	30	30	%
Height [mm]	h1	60	60	#\$"
Weight approx. [kg]		" z	" z+	\$z
Isolation resistance		>10 M		≥10 MΩ
Derating horizontal mounting [%]		20		

